

THE COPYRIGHT OF THIS DRAWING IS VESTED WITH CW O'BRIEN ARCHITECTS LIMITED AND MUST NOT BE COPIED OR REPRODUCED WITHOUT THE CONSENT OF THE COMPANY.
 FIGURED DIMENSIONS ONLY TO BE TAKEN FROM THIS DRAWING. DO NOT SCALE.
 ALL CONTRACTORS MUST VISIT THE SITE AND BE RESPONSIBLE FOR CHECKING ALL SETTING OUT DIMENSIONS AND NOTIFYING THE ARCHITECT OF ANY DISCREPANCIES PRIOR TO ANY MANUFACTURE OR CONSTRUCTION WORK.

DESIGN INTENT DRAWING

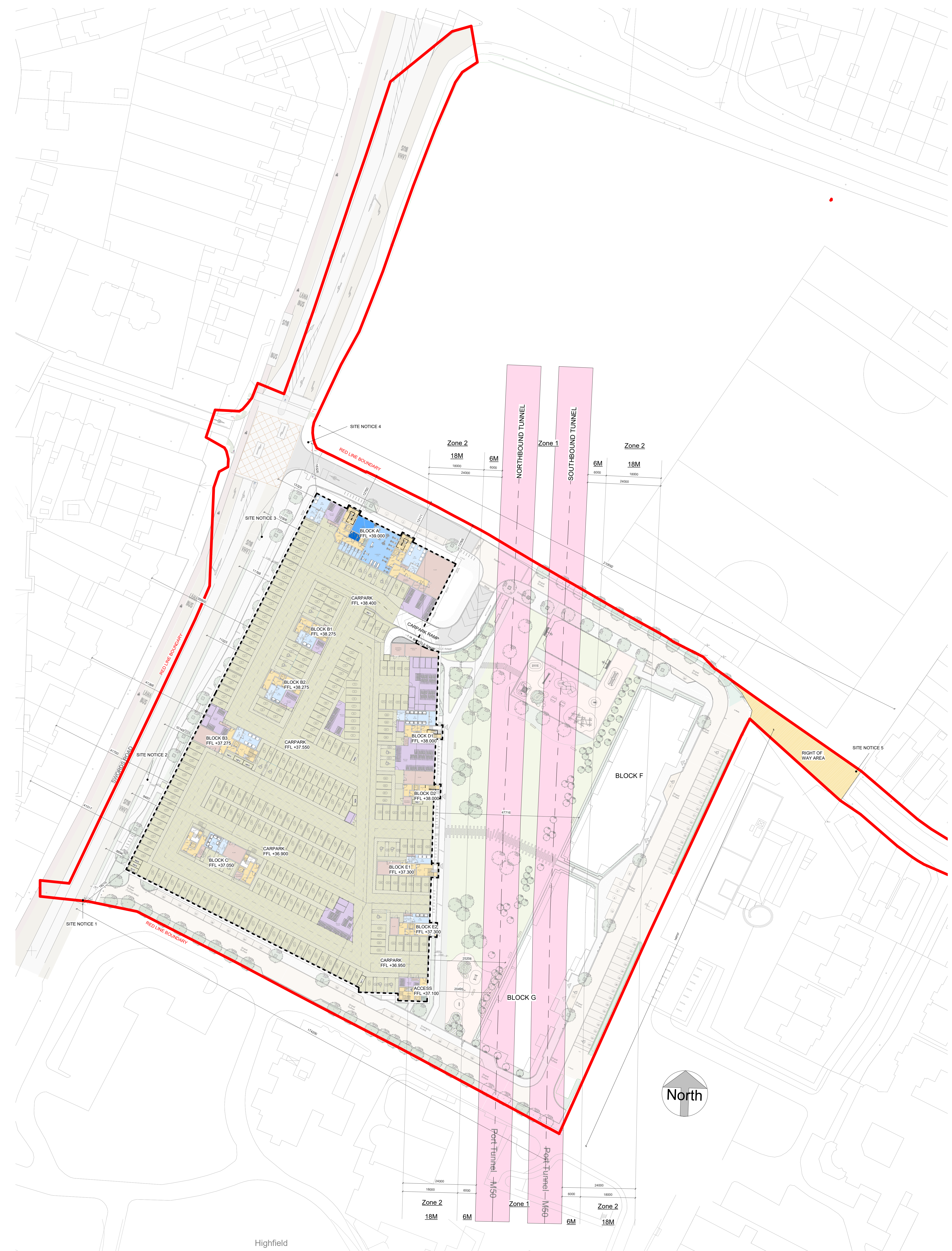
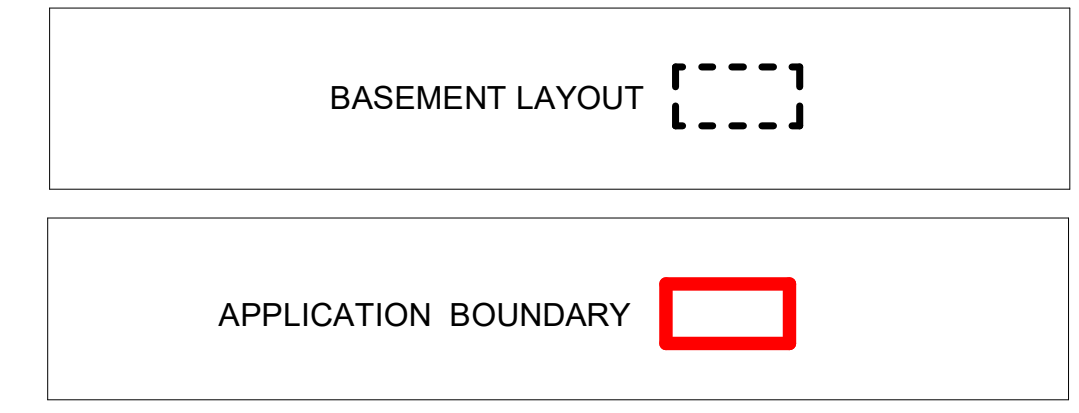
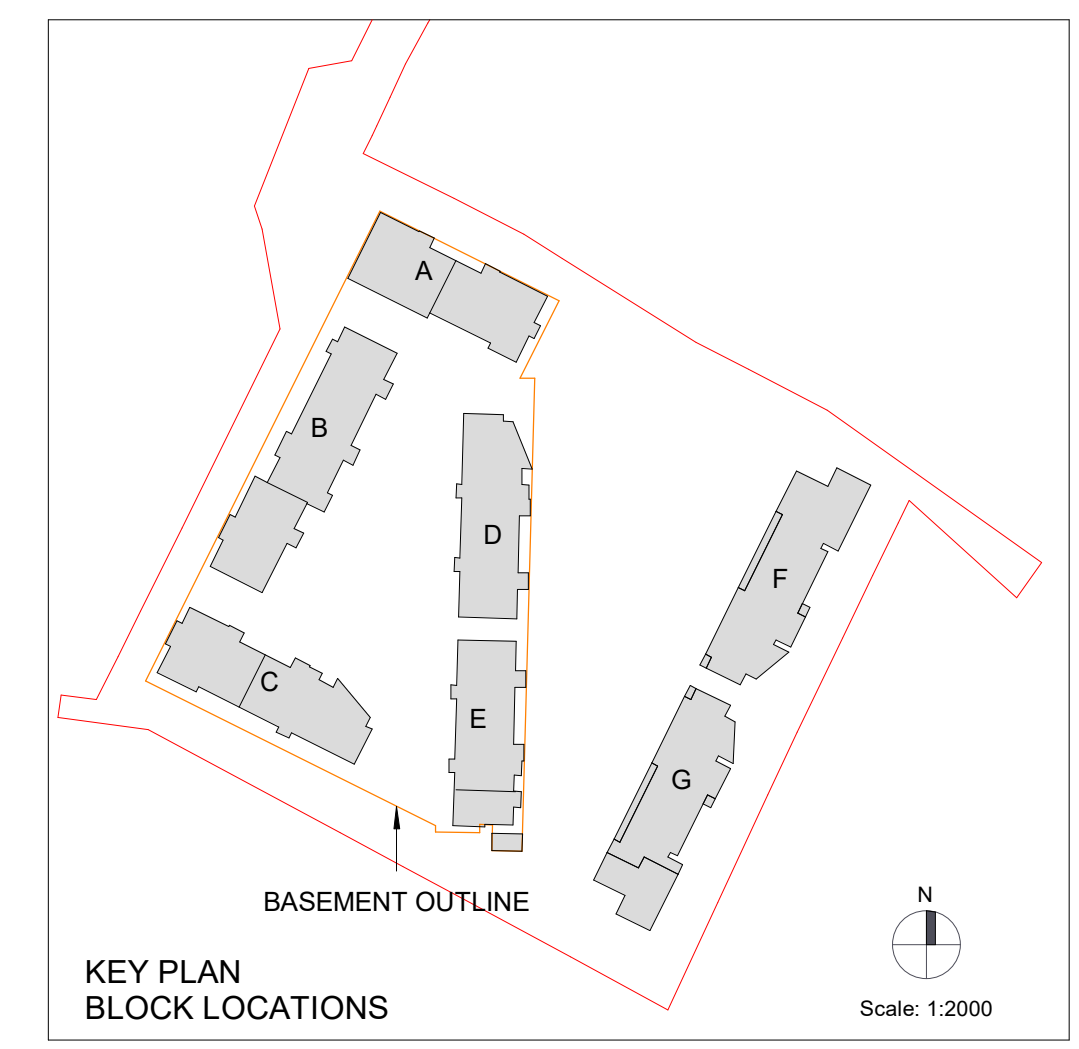

1 SITE BASEMENT PLAN
1:500

Rev	Date	Description	Issued By

Project Stage: **PLANNING**

Client: Eastwise Construction Swords Limited

Project: Hartfield Place
Swords Road, Whitehall, Dublin 9
D09 C7F8

Drawing Title: **SITE BASEMENT PLAN**

Drawn	Checked	Paper Size	Scale	Date
DP	CM	A0	As Indicated	Mar. 2022

Project No.	Drawing No.	Classification	Revision
HARTPL	000503		

File Name: HARTPL-CWO-SM-B1-DR-A-000503

Status: **S2-Suitable For Information**

C+W O'BRIEN ARCHITECTS

No. 1 Sarsfield Quay, Dublin 7, D07 R9FH
t: 01 518 0170 e: admin@cwoarchitects.ie
Dublin | Cork | Galway | London | UK & Europe +
www.cwoarchitects.ie

Please consider the environment before printing this sheet